



# DATA SHEET

## Murfor® EFS

FOR MASONRY WITH THIN BED JOINTS



### What is Murfor® EFS?

Murfor® EFS is the masonry reinforcement solution from industry specialist Bekaert that will allow you to perform your masonry works in full confidence. Murfor® EFS is a prefabricated bed joint reinforcement consisting of two parallel wires welded together with a continuous truss wire. Complying with today's toughest industry standards, Murfor® EFS significantly increases the strength of your masonry and the integrity of your construction.

### Why use Murfor® EFS?

Combining its excellent performance with cost-effectiveness, Murfor® EFS offers you and your construction projects:

- new architectural possibilities
- structural performance
- crack control

Having a minimal thickness, Murfor® EFS can easily be positioned in the joints. Thanks to the geometry and the well-chosen length of Murfor® EFS elements, use on the construction site has been made easy.

### Bekaert will advise on the most suitable Murfor® type for your application.

Ask for our recommendations on type, amount and positioning at:

[www.bekaert.com/building](http://www.bekaert.com/building)  
[infobuilding@bekaert.com](mailto:infobuilding@bekaert.com)

All Bekaert company names are trademarks owned by NV Bekaert SA Zvevegem - Belgium. Modifications reserved. All details describe our products in general form only. For detailed information, product specifications available on request. © 2008 Bekaert

### POSITION OF Murfor® EFS IN THE THIN BED JOINTS

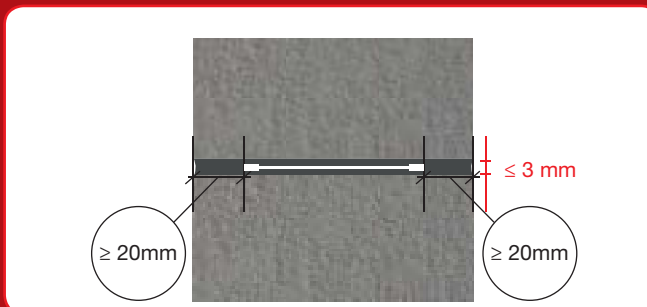

### GEOMETRY

Width (mm)	Diameter (mm)	Diameter (mm)
40	8 x 1,50	1,50
90	8 x 1,50	1,50
140	8 x 1,50	1,50
190	8 x 1,50	1,50



### COATING

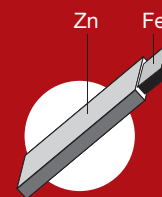

**EF3/Z (Zn)**  
 • For masonry exposed to a dry environment



**EF3/S (AISI 302)**  
 • For masonry exposed to dampness or an aggressive environment

### PACKAGING



25 pieces per bundle (75 m)  
 40 bundles per pallet (3050 m)

### STORAGE

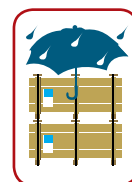

**KEEP DRY**

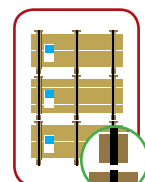

**RIGHT**

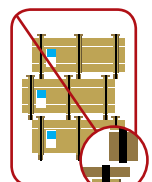

**WRONG**

### APPROVALS



ISO



CE



KOMO



ATG

• **CE LABEL:** Murfor® is CE marked according to EN 845-3: masonry bed joint reinforcement. For detailed info: "EC declaration of conformity" available on request.

• **OTHER APPROVALS:** Bekaert is close to the market. Bekaert seeks conformance to every necessary, national product quality standard, in case one or more requirements are not covered in the CE or ISO 9001 certifications. Other Murfor® approvals are Zulassung DIBt, Mursenter and ITB.

### Murfor® DESIGN



Look at Murfor® design: [www.bekaert.com/building](http://www.bekaert.com/building)